

**SLAB TO SLAB DETAIL**

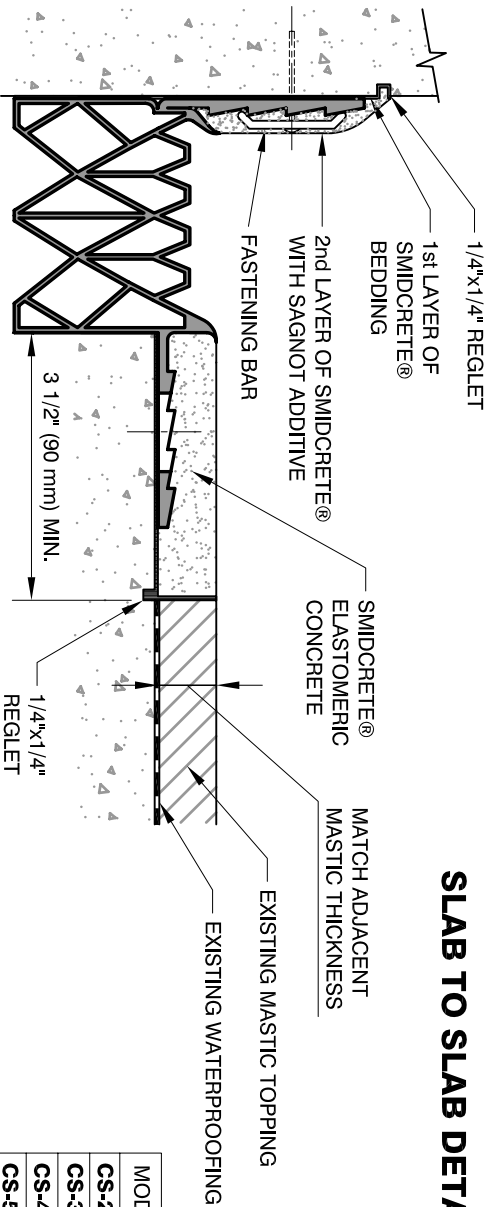

**SLAB TO WALL DETAIL**

MODEL	MOVEMENT	NOMINAL A	MIN. A.	MAX. A.
CS-250	1 1/2 (38)	1 1/2 (38)	1 (25)	2 1/2 (64)
CS-325	2 (51)	2 (51)	1 1/4 (32)	3 1/4 (83)
CS-400	2 1/2 (64)	2 1/2 (64)	1 1/2 (38)	4 (102)
CS-500	3 1/4 (83)	3 (76)	1 3/4 (44)	5 (127)
CS-600	3 7/8 (98)	3 1/2 (89)	2 1/8 (54)	6 (152)

**BOLD NUMBERS ARE SHOWN IN INCHES**  
**LIGHT NUMBERS IN ( ) ARE MILLIMETERS**



WEB: WWW.SMID.CA E-MAIL: INFO@SMID.CA

Title \_\_\_\_\_

**CS-SERIES MEMBRANE SYSTEM**  
**MASTIC WATERPROOFING**

Date JUL '05 Scale NTS Drawn By WK Checked By CS Dwg No TD-CS-13

REVISIONS			
No.	Description	By	Date
1.	REVISED MEMBRANE SECTION	CS	JULY 05

The information contained herein is the proprietary property of SMID SYSTEMS INC. No portion of it may be reproduced by any means or used in any form except for the purpose for which it was furnished. All rights of design and invention are hereby reserved.